

### Bale Film & Additive Carrier

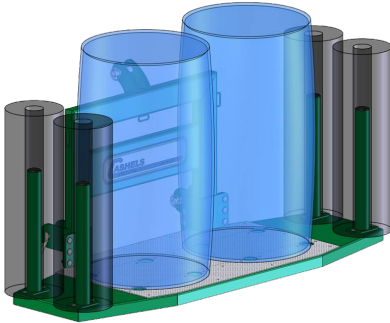

### Bale Film Carrier (No Galv Plate)

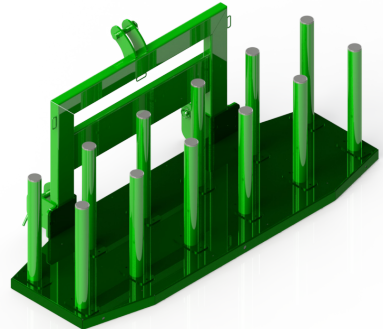

The **Cashels Bale Film & Additive Carrier** has been developed to cater for the transport of rolls of bale film and silage additive.

The unique and flexible design allows for various configurations depending on the user's requirements. One or two barrels of additive may be transported with four/eight rolls of bale film. Alternatively when all of the tubes are added the unit can carry up to twelve rolls of bale film.

#### KEY FEATURES

- Rugged bolt-on platform assembly fabricated from sheet steel
- Galvanised chequered floor plate for strength, grip and durability
- Sleeved upright tubes
- Heavy duty box-section frame assembly
- Tie-down links fitted for securing the barrels of additive

#### OPTIONS

- 3 Point Linkage
- Triangle Quick-Attach

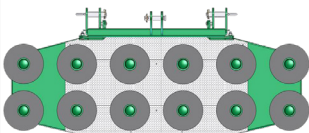

**Plan View showing twelve rolls of bale film**

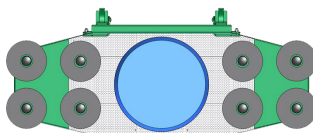

**Plan View showing one barrel of additive and eight rolls of bale film**

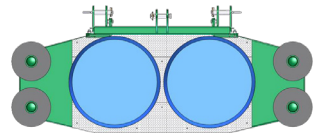

**Plan View showing two barrels of additive and four rolls of bale film**

Model	Length (mm)	Width (mm)	Height (mm)	Linkage	Load Capacity (kg)	Net Weight (kg)	Tractor (hp)
Standard	700	1745	700	CAT 1 & 2	600	140	60+

# **GREG ALLAN**

---

## **FARM MACHINERY**

---

Phone:

**5231 5136**

408 Princes Hwy, Colac West, Vic, 3249

[www.gregallanfarmmachinery.com.au](http://www.gregallanfarmmachinery.com.au)